

PROPOSED CONSTRUCTION AREA OF G+4 RESIDENTIAL FLAT BUILDING OWNER OF LAND 1) BANI MUKHERJEE, 2) DIBENDU HAZRA, 3) KRISHNENDU HAZRA, & 4) KALYAN HAZRA. SCHEDULE :- MOUZA :- KANAINATSAL, J.L. NO. :- 76, R.S. & L.R. PLOT NO. :- 99 & 103, L.R. KHATIAN NO. :- 3277, 3139, 340, 1546, HOLDING NO. :- 352, MAHALLA :- KANAINATSAL NORTH, WARD NO. :- 12, UNDER BURDWAN MUNICIPALITY.

TOTAL LAND AREA :- 6407.00 SFT. = 595.45 SQ MT.

- NOTES :-
1. HOSPITAL -- 2 KM.
 2. SCHOOL -- 1 KM.
 3. BUS STOP -- 500 MT.
 4. G. T. ROAD -- 500 MT.
 5. COORDINATES -- 23.226 LAT. -- 87.873 LOG.

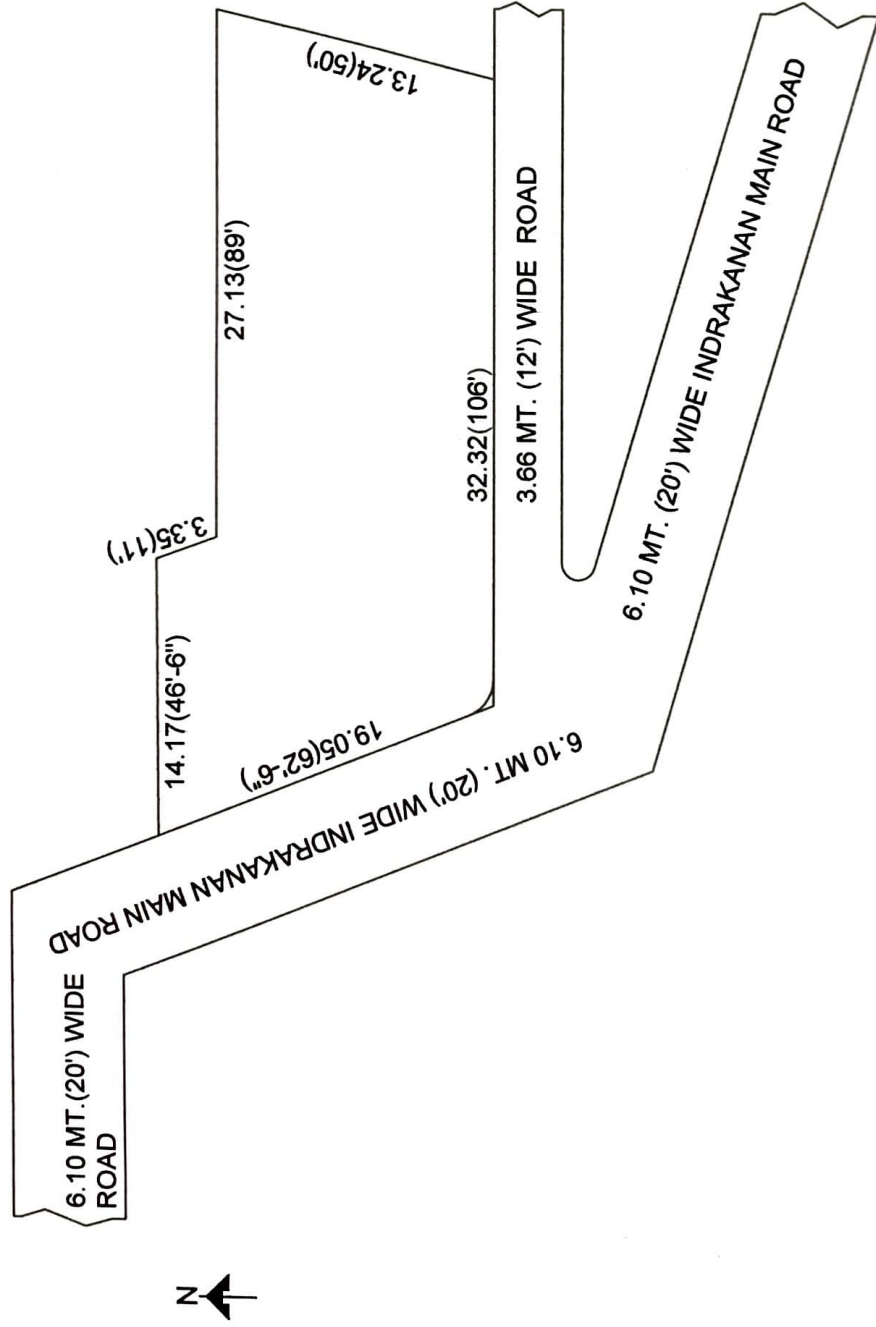

Uttam Kumar Roy

DRAWN BY:-
 Uttam Kumar Roy
 Reg. No-BM/LBS-I/18-19/25